

Burnbridge, Seaton Burn, NE13

OO £160,000



Full Description

Alexander Hudson Estates are thrilled to introduce to the market this well-presented semi-detached home in Seaton Burn, occupying a desirable corner plot and offered with no onward chain. Positioned within easy reach of local amenities, transport links, and surrounding green spaces, the property also benefits from generous outdoor space with lawns to the front, side, and rear.

On the ground floor, you'll find a bright and welcoming lounge that provides a perfect space to relax or entertain. To the rear, the kitchen and dining area is thoughtfully arranged with ample workspace and room for a dining table, creating a sociable hub of the home.

Upstairs, the property features two bedrooms, including a generous main bedroom and a second room that would work well as a guest room, child's bedroom, or home office. A family bathroom serves both rooms, and additional storage is available from built-in cupboards.

Externally, the front of the property includes a lawned garden, a paved double driveway and garage providing private parking for added convenience. Benefitting from its corner plot position, the property also enjoys additional lawned areas to the side and rear. The rear garden

features a spacious, low maintenance patio area.

Seaton Burn is a small village on the northern edge of Newcastle upon Tyne, offering a semi-rural feel while remaining well connected to the city and surrounding areas. Situated close to Wideopen and near the A1 and A19, it provides convenient transport links for commuting across the region. The area is primarily residential, with a mix of traditional and modern housing, and benefits from nearby green spaces such as country parks and open countryside, making it appealing for those seeking a quieter lifestyle with easy access to urban amenities

Features

- Well presented two bedroom semi-detached home.
- Bright and airy reception space.
- Allocated parking and garage offering ample parking.
- Within walking distance to local schools, amenities and transport links.

Contact Us

Alexander Hudson

The Printworks, 20 Arrow Close
Killingworth
Newcastle Upon Tyne
NE12 6QN

T: 0191 268 7433

E: sales@alexanderhudson.co.uk







Energy Efficiency Rating

	Current	Potential
Very energy efficient - lower running costs		
(92 plus) A		
(81-91) B		88
(69-80) C	72	
(55-68) D		
(39-54) E		
(21-38) F		
(1-20) G		
Not energy efficient - higher running costs		
England & Wales	EU Directive 2002/91/EC	

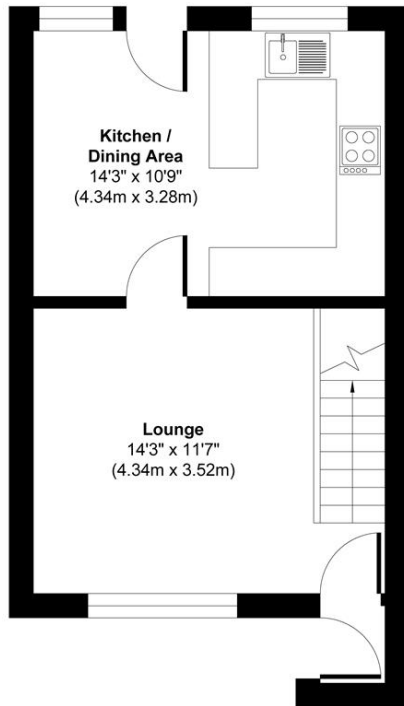
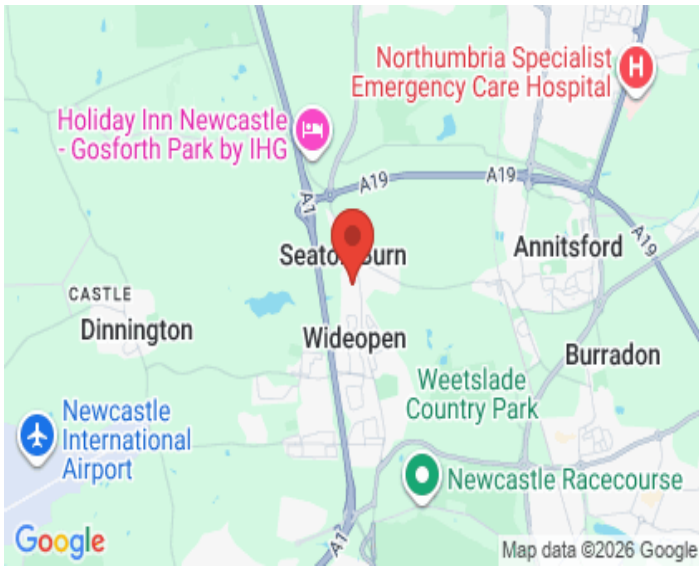

Ground Floor
Approximate Floor Area
334 sq.ft
(30.99 sq. m)

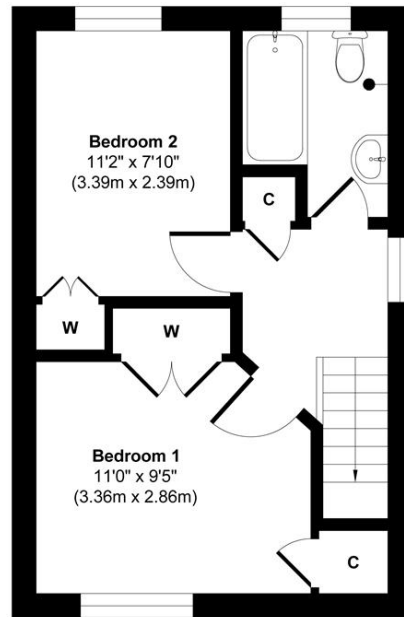

First Floor
Approximate Floor Area
324 sq.ft
(30.11 sq. m)

Approx. Gross Internal Floor Area 658 sq. ft / 61.10 sq. m

Illustration for identification purpose only, measurements approximate and not to scale, unauthorized reproduction is prohibited. All rights reserved for Alexander Hudson Estates