

Northfield Drive, West Moor, NE12

OIRO £350,000



Full Description

Alexander Hudson Estates introduces to market this three-bedroom, detached family home located within the increasingly popular residential area of West Moor, close-by to local shops, restaurants, and transport links. With excellent schooling also nearby, this property represents a fantastic opportunity to acquire a family home in a popular area.

This well-proportioned home offers a versatile and comfortable layout, the ground floor is thoughtfully arranged, featuring a spacious living room that provides an inviting setting for relaxation and entertaining. A separate office offers a quiet and practical space for working from home or study. The kitchen is centrally positioned, with easy access to the main living areas, creating a natural hub for day-to-day life. From here, there is convenient access to the adjoining garage, adding practicality and additional storage options.

Upstairs, the principal bedroom benefits from built-in storage, while the remaining bedrooms offer flexibility for family, guests, or additional workspace. A well-appointed family bathroom serves all bedrooms, completing the first-floor accommodation. Externally, the spacious rear garden with lawn and patio, offers ample space for outdoor entertaining,

West Moor is a popular residential suburb with roots in the 19th-century coal mining communities. Today, it combines a friendly village-like atmosphere with a mix of traditional and modern homes, appealing to both families and professionals alike. Local amenities include shops, a local bakery, Lidl supermarket, independent cafés and businesses such as The Printworks and The Croft, as well as Miller & Carter Steakhouse. Green spaces include Gosforth Nature Reserve and Killingworth Boating Lake. Excellent transport links via the A19, A1, and metro stations at Longbenton and Four Lane Ends provide easy access into Newcastle.

Features

- Well-situated three-bedroom detached family home.
- Integral garage providing ample practicality and storage.
- Generously proportioned living and dining spaces.
- Situated within sought-after location of West Moor, close to schooling, transport links and amenities,

Contact Us

Alexander Hudson

The Printworks, 20 Arrow Close
Killingworth
Newcastle Upon Tyne
NE12 6QN

T: 0191 268 7433

E: sales@alexanderhudson.co.uk









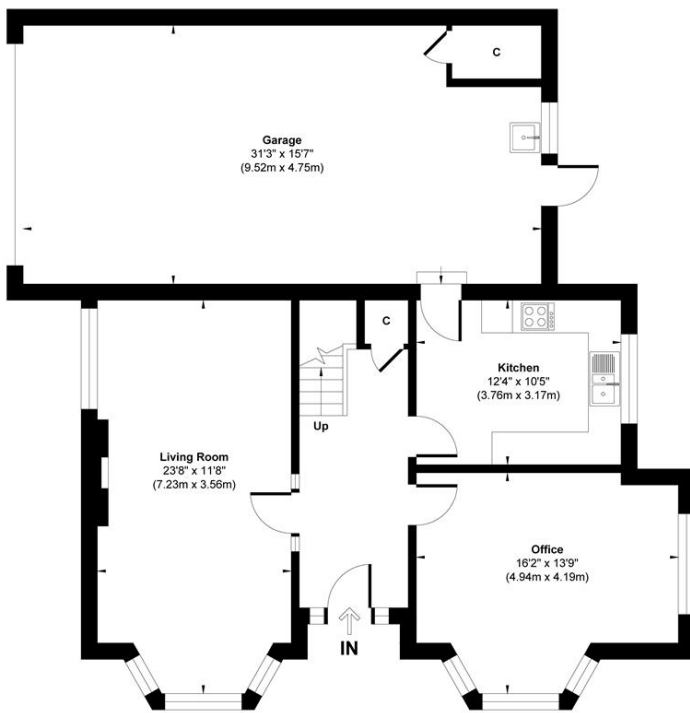

Ground Floor
 Approximate Floor Area
 1197 sq.ft
 (111.18 sq.m)



First Floor
 Approximate Floor Area
 652 sq.ft
 (60.59 sq.m)

Approx. Gross Internal Floor Area 1849 sq. ft / 171.77 sq. m (Including Garage)

Illustration for identification purpose only, measurements approximate and not to scale, unauthorized reproduction is prohibited. All rights reserved for Alexander Hudson Estates