

Yates Close, Killingworth, NE12

OIRO £180,000



Full Description

Alexander Hudson Estates introduces this immaculately presented; two-bedroom semi-detached home located in the popular residential suburb of Killingworth. Local amenities including shops, schools and leisure facilities are all close-by, with beautiful scenic views of the near-by boating lake providing a tranquil setting.

Briefly comprising of an entrance hallway, living room with French doors, U-shaped kitchen, and WC. On the first floor lies two double bedrooms and a stylish and modern bathroom. To the front of the property is a driveway and attached garage whilst a landscaped garden sits at the rear providing the perfect place to relax and enjoy the warm summer months with friends and family.

The property is well located, being only a short walk to the nearest supermarket, and a ten-minute walk to the local shopping centre, which includes various shops and eateries whilst a leisure centre is within a five-minute walk, providing a swimming pool, indoor sports courts, and a gym. Easy access to Newcastle City Centre and North Tyneside is provided by the local bus routes, with local primary and secondary schools also within walking distance.

Features

- Immaculately presented throughout with beautiful wood flooring and a warm and cosy feel
- Attached garage and driveway providing ample off-street parking and additional storage
- Landscaped, private garden fully-enclosed by a tall wooden fence
- Sought-after location close-by to a range of amenities, schooling and transport links

Contact Us

Alexander Hudson

The Printworks, 20 Arrow Close
Killingworth
Newcastle Upon Tyne
NE12 6QN





Energy Efficiency Rating

	Current	Potential
Very energy efficient - lower running costs		
(92 plus) A		97
(81-91) B	83	
(69-80) C		
(55-68) D		
(39-54) E		
(21-38) F		
(1-20) G		
Not energy efficient - higher running costs		
England & Wales	EU Directive 2002/91/EC	





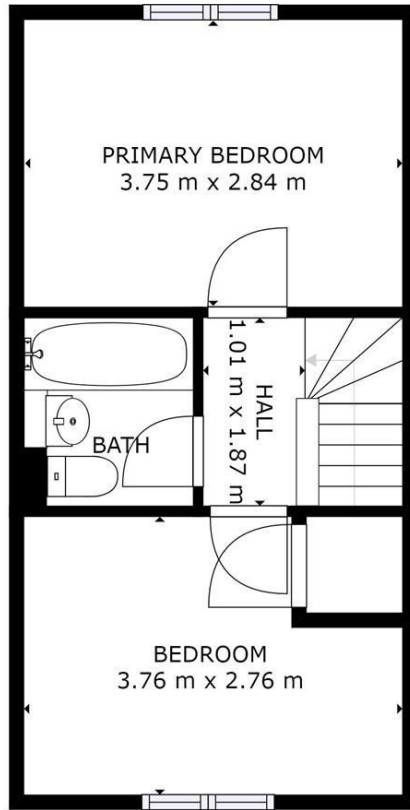

FLOOR 2

GROSS INTERNAL AREA
FLOOR 1: 30 m², FLOOR 2: 29 m²
TOTAL: 59 m²
SIZES AND DIMENSIONS ARE APPROXIMATE, ACTUAL MAY VARY.

