



Alexander Hudson Estates

Sales Particulars

Alexander Hudson Estates

South Street, Shiremoor, NE27



The Property

Alexander Hudson Estates are pleased to welcome to the market this attractive three bedroom terraced home, ideally situated in a popular location in NE27.

The property offers well proportioned accommodation which briefly comprises: a welcoming hallway leading to a generous lounge, followed by a modern kitchen and dining area with French doors opening onto the rear yard, allowing plenty of natural light. The ground floor also features a contemporary bathroom with a bath, separate shower cubicle, floating vanity sink, and W.C.

To the first floor there are two comfortable double bedrooms and a third single bedroom, perfect for a home office or nursery. Externally, the property boasts a fully enclosed rear yard, ideal for outdoor entertaining or children's play.

Perfectly positioned, the home is within walking distance of local schools and excellent transport links, including Shiremoor and Northumberland Park Metro Stations, providing easy access to Newcastle City Centre and the coast at Whitley Bay. Nearby, Northumberland Park shopping complex offers a variety of amenities, including a Sainsbury's, eateries, and a GP surgery.

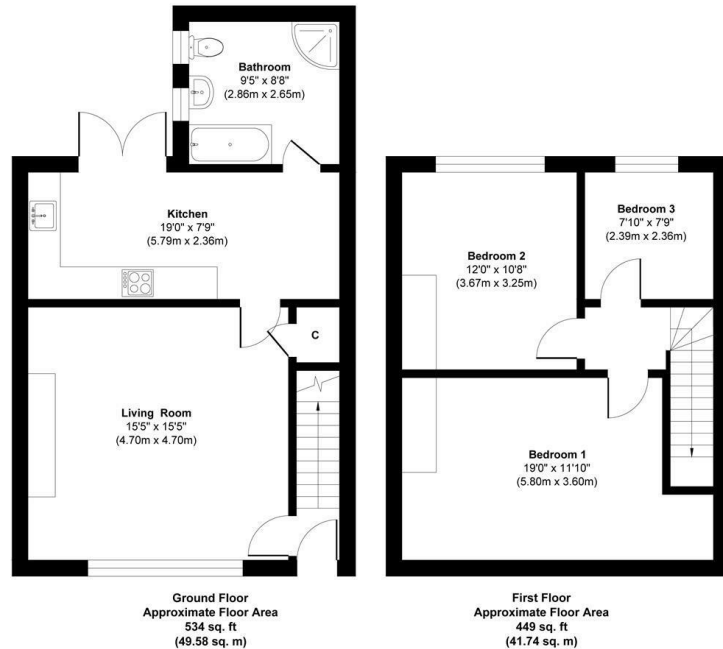

Approx. Gross Internal Floor Area 983 sq. ft / 91.32 sq. m
Illustration for identification purpose only, measurements approximate
and not to scale, unauthorized reproduction is prohibited. All rights reserved for
Alexander Hudson Estates

Freehold
Council Tax: A
EPC Rating: 72





Alexander Hudson Estates
The Printworks
20 Arrow Close
NE12 6QN

0191 268 7433
sales@alexanderhudson.co.uk